

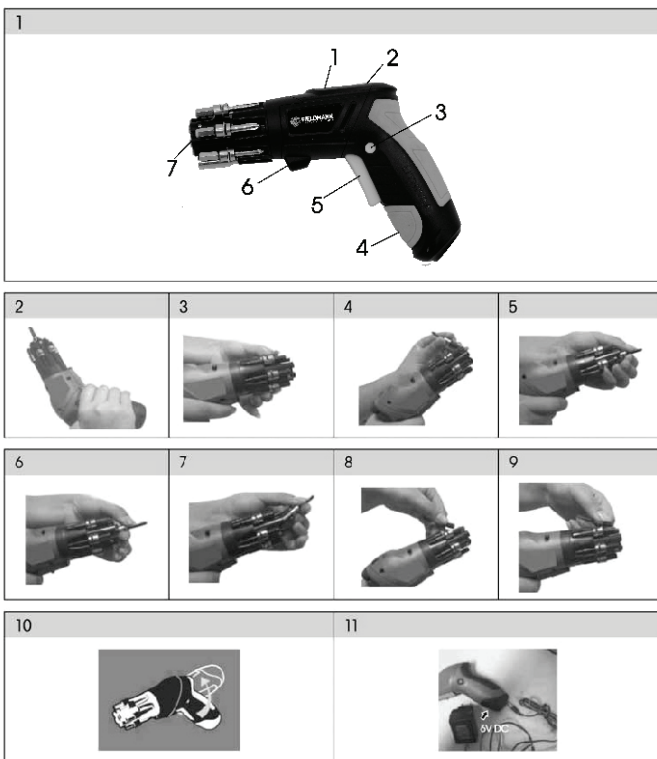

FDS 10102-A

English	2	Português	32
Čeština	8	Español	40
Slovenčina	14		
Magyarul	20		
Polski	26		



GENERAL SAFETY INSTRUCTIONS

Important Safety Instructions

- ✿ Read the Instruction Manual attentively before use.
- ✿ Carefully remove the tool and any accessories from the box. Do not discard any of the packing materials until all parts are accounted for.
- ✿ Keep the product in a dry place.
- ✿ Read all warnings and instructions attentively. Failure to follow all warnings and instructions listed below may result in electric shock, fire and/or serious personal injury.
- ✿ Read operators manual carefully. Learn its applications and limitations, as well as the specific potential hazards related to this power tool. Following this rule will reduce the risk of electric shock, fire, or serious injury.
- ✿ Check whether the available power supply parameters correspond to the voltage parameters specified on the tool.
- ✿ Check whether the power tool and connections are not damaged.
- ✿ Connect the power cord to the outlet only when the tool is switched off.
- ✿ Switch on the tool prior you place it on the workpiece.
- ✿ Take all safety measures to reduce a risk of electric shock. Avoid body contact with earthed or grounded surfaces, such as pipes, radiators, ranges and refrigerators.
- ✿ Sudden temperature changes may result in water condensation on live parts. Prior to use: Let the power tool reach the workplace room temperature.
- ✿ Do not use machines, tools and recommended accessories for any than intended purposes!
- ✿ Clamp the workpiece safely. Secure the workpiece to be drilled in a vice or with clamps to keep it from turning as the drill bit rotates.
- ✿ Dress properly. Do not wear loose clothing or jewellery. Loose clothes, jewellery or long hair can be caught in moving parts. Wear safety shoes and gloves. Contain long hair.
- ✿ Should dust, chips and sawdust result from your activity or should you work above your head, always wear safety goggles and dust mask, where appropriate.
- ✿ While impact drilling, wear suitable ear protective equipment.
- ✿ While working on ladders, scaffolding or upper floors, always stand on a firm base.
- ✿ Do not expose power tools to rain or wet conditions. Do not immerse the tool into water.
- ✿ When operating a power tool outdoors, use an extension cord and other accessories suitable for outdoor use.
- ✿ Do not operate power tools in explosive atmospheres.
- ✿ When the tool is handed over to the third person, the Instruction Manual shall always be included.
- ✿ The power tool can be repaired only by a qualified specialist and with the original spare parts.

- ⚠ WARNING!** Do not use a power tool while you are tired or under the influence of drugs, alcohol or medication. A moment of inattention while operating power tools may result in serious personal injury. Do not use the power tool in any of the following situations.
- ✳ Keep the power tool out of reach of children
 - ✳ Store idle power tools in the original package in a safe place and out of reach of children.
 - ✳ Disconnect the power cord from the power outlet before making any adjustments, changing accessories, or storing power tools
 - ✳ Do not abuse the cord. Never use the cord to carry the charger. Do not pull the cord to disconnect the power tool from the power source
 - ✳ When working: Do not let the motor stop if the power tool is loaded
 - ✳ Keep the workplace clean and tidy. A messy workplace increases a risk of injury!
 - ✳ Do not assume unusual body positions while drilling
 - ✳ Avoid unintentional power tool switching or startup

Packaging

The product is placed in a package preventing damage during transport. This package is a raw material therefore it can be handed-over for recycling

Instructions for use

Before beginning to work with the machine, read the following safety rules and instructions for use. Familiarize with operating elements and the proper use of the device. Keep the manual in a safe place for future reference. We recommend keeping the original package including the inner packaging materials, cash voucher and guarantee card for a period of warranty at minimum. For a case of transportation, pack the machine into the original box from the manufacturer, thus ensuring a maximum protection of the product during a possible transport (e.g. moving or sending into a service station)

- 📖 Note:** If you hand the machine over to next persons, hand it over together with the manual. Adherence to the attached instructions for use is a precondition for the proper use of the machine. The operation manual includes also instructions for operation, maintenance and repairs

The manufacturer does not take any responsibility for accidents or damages resulting from the failure to adhere to this manual.



Tento produkt je vyroben v souladu se schválenými normami.



Read the Instruction Manual attentively prior to use.



Dvojitá izolace.



Používejte ochranu zraku a sluchu.

MACHINE DESCRIPTION AND INCLUDED CONTENTS

Machine description (see pic. 1)

- ① LED battery charge display
- ② Handle pivot switch
- ③ Rotation direction switch
- ④ Charging connector jack
- ⑤ Switch
- ⑥ LED light
- ⑦ Chuck

Supplied contents

Carefully take the machine out of the packaging and check whether all the following parts are present:

- ✿ Cordless screwdriver with a head including 6 bits on rotating arms.
- ✿ Battery charger
- ✿ User's manual

If there are parts missing or they are damaged, please contact the vendor from whom you bought the machine.

ASSEMBLY OF THE MACHINE

The cordless screwdriver is equipped with a unique system of a head with 6 bits, which brings many advantages.

 **Note:** Proceed step by step according to the user's manual and use the pictures as a guide so that the assembly process is as easy as possible.

Attaching bits (see pic. 2)

Select the desired bit (pic. 3) from the magazine, and fill it out together with the holder from the storage position (pic. 4) and insert the end of the bit into the chuck (pic. 5).

Removing bits (see pic. 6)

Turn the bit holder back to its storage position (pic. 7, 8) and make sure that the holder is firmly secured (pic. 9).

Changing bits

Select another of the 6 bits on the head and proceed again according to the instructions above.

 **Note:** Do not use working tools that are not proportioned for work in the holder.

Setting the working position of the machine (see pic. 10)

Press the handle pivot switch (pic. 1, no. 2) and turn the handle clockwise until it clicks in: in this way the handle will come into a horizontal position relative to the head of the screwdriver. Press the handle pivot switch (pic. 1, no. 2) and turn the handle back anticlockwise again until it clicks into the pistol position of the screwdriver.

PUTTING INTO OPERATION

Charging the machine (see pic. 11)

If you wish to charge the battery, connect the adapter to a power socket (230 V - 50 Hz) and insert the charger connector into the jack in the handle of the machine (pic. 1, no. 4). The red charging indicator light will turn on.

 **Note:** The recharging time is in the range from 3 to 5 hours.

Turning on the machine

 **ATTENTION:** Start or release the start switch carefully according to the manufacturer's instructions.



Turn on the charged machine using the On/Off switch (pic. 1, no. 5). Operation will be shown on the LED display (pic. 1, no. 1). Turn off the machine by releasing the switch, the chuck will stop turning.

 **ATTENTION:** The chuck continues to rotate for a while after the machine has been turned off.

INSTRUCTIONS FOR PROPER USE

Screwing/unscrewing

The screwdriver is equipped with a screwing/unscrewing switch (pic. 1 no. 3), which changes the rotation direction of the chuck.

1. To screw - clockwise rotation of the chuck - set the switch left (press the switch marked L), a green indicator light will turn on .
2. To unscrew - anticlockwise rotation of the chuck - set the switch right (press the switch marked R), a green indicator light will turn on .

TECHNICAL SPECIFICATIONS

Screwdriver:	
Battery	3,6 V/1300 mAh
Maximum speed	180 rpm
Level of acoustic pressure	$L_{pa} < 72,8 \text{ dB (A)}$
Vibrations	acceleration $< 1,5 \text{ m/s}^2$
Charger:	
Input charging voltage	230V~, 50Hz
Charging time	3 - 5 hours
Electric shock protection class	class II
Output voltage	5 V, direct current; 500 mA

Amendments to text and technical parameters are reserved.

Changes in the text, design and technical specifications may change without prior notice and we reserve the right to make these changes.

DISPOSAL

INSTRUCTIONS AND INFORMATION REGARDING THE DISPOSAL OF USED PACKAGING MATERIALS

Dispose of packaging material at a public waste disposal site.

DISPOSAL OF USED ELECTRICAL AND ELECTRONIC APPLIANCES



The meaning of the symbol on the product, its accessory or packaging indicates that this product shall not be treated as household waste. Please, dispose of this product at your applicable collection point for the recycling of electrical & electronic equipment waste. Alternatively in some states of the European Union or other European states you may return your products to your local retailer when buying an equivalent new product. The correct disposal of this product will help save valuable natural resources and help in preventing the potential negative impact on the environment and human health, which could be caused as a result of improper liquidation of waste. Please ask your local authorities or the nearest waste collection centre for further details. The improper disposal of this type of waste may fall subject to national regulations for fines.

For business entities in the European Union

If you wish to dispose of an electrical or electronic device, request the necessary information from your seller or supplier.

Disposal in other countries outside the European Union

If you wish to dispose of this product, request the necessary information about the correct disposal method from local government departments or from your seller.



This product meets all the basic EU regulation requirements that relate to it.

Changes to the text, design and technical specifications may occur without prior notice and we reserve the right to make these changes.

FAST[®]

FAST ČR, a.s.

Černokostelecká 1521, 251 01 Říčany, Czech Republic
tel.: +420 323 204 111, fax: +420 323 204 110

DECLARATION OF CONFORMITY

Manufacturer:

FAST ČR, a.s.
Černokostelecká 2111, 100 00 Praha 10, Czech Republic
VAT no: CZ26726548

Product / brand: CORDLESS SCREWDRIVER/ FIELDMANN

Type / model: FDS 10102 A

230V~, 50 Hz, DC 3,6V

The product is inline with directives and regulations listed below:

EC Council Directive 2006/42/EC Machinery
EC Directive for Electromagnetic Compatibility (EMC) No.2014/30/EU
EC Directive for RoHS 2011/65/EU

and norms:

EN 62841-1-2:2015
EN 62841-2-2:2014
EN 55014-1:2006+A1+A2
EN 55014-2:2015
EN 61000-3-2:2014
EN 61000-3-3:2013



Place of issuance: Prague

Name: Ing. Zdeněk Pech
Chairman of the Board

Date of issuance: 1.9.2022

Signature:

FAST[®] FAST ČR, a.s.
Černokostelecká 1521, 251 01 Říčany
IČO: 26726548 tel.: +420/ 323 204 111
DIČ: CZ26726548 fax: +420/ 323 204 110

IČO: 26 72 65 48, **DIČ:** CZ-26 72 65 48

Bankovní spojení: Komerční banka Praha 1, č.ú. 89309011/0100, Česká spořitelna Praha 4, č.ú. 2375682/0800
ČSOB Praha 1, č.ú. 8010-0116233383/0300