

NexFlex Led Neon Light

NQT1010WW-9.6W5M24FC



Product Specification



Product features

- Anti-yellowing and heat resisting silicone glue, chemical resistance acid and alkaline,available for extremely terrible outdoor environment.
- Uniform and soft luminance, no light spot.
- Super brightness large chip, golden wire welded and copper led holder for quicker heat dissipation, higher stability, longer life span.
- Leadless SMT technique (RoHS certificated), smooth welding joint, firm connection of led and pcb.



Specification



Horizontal Bending (Silicone)

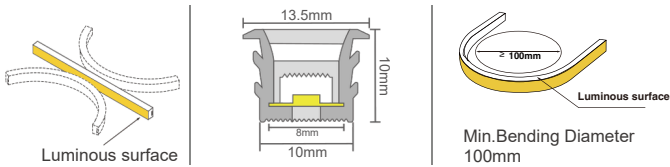

 IP20 Protection	 Flame Resistant	 UV Resistant	 Solvents Resistant	 Saltwater Resistant
 Dirt Resistant	 CRI90	 3 Years Warranty	 Ambient Working	 Anti Yellowing

Model Number	NQT1010WW-9.6W5M24FC	Size (mm)	10*10
PCB Limited (mm)	8mm	IP Grade	IP20
Working Temperature	-25 to 60°C	N.W.(G/M)	130g



NQT1010WW-9.6W5M24FC - Accessories



Solderless Power Cable
(2m, L813 Male, Direct Plug-in Design)

Recommend LED strip parameters

(1) NQT1010WW-9.6W5M24FC WHT

SMD2216, 140LED/meter									
Part number	Color	Lumen/M CRI 80	Lumen/M CRI 90	Unit cut	Cut every (LEDS)	LED Qty/M	Voltage	Power/M	Max run length
	WW 	624	562	cut anywhere	1	140	24V	9.6W	5 meters from one end
	NW 	653	588						
	CW 	643	580						

Product system solutions

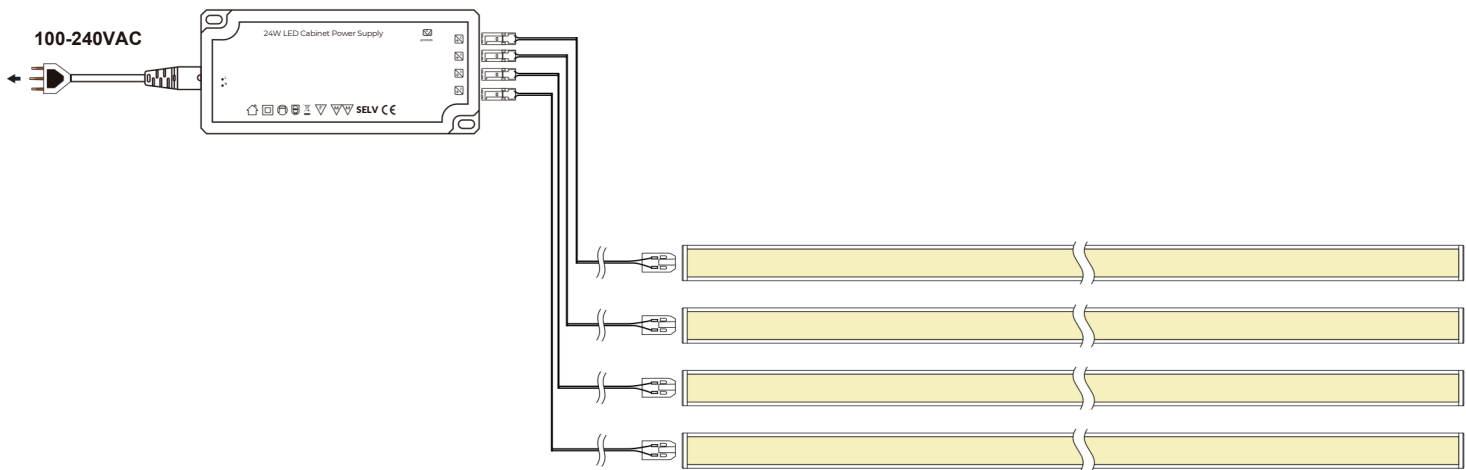

Cut mark



Free Cut Version: Cut Anywhere

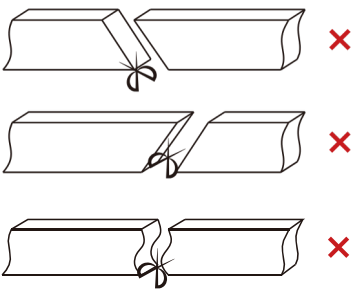

Please do not arbitrarily cut or cut into a bevel and arc section.

Installation

This product is suitable for embedded installation only. Recommended slot size: Width 10mm, Depth 11–15mm. Gently press the neon sleeve into the slot.



Installation of carrier

1. When installing the LED strip, install it from both ends at the same time, installation from one direction is prohibited.

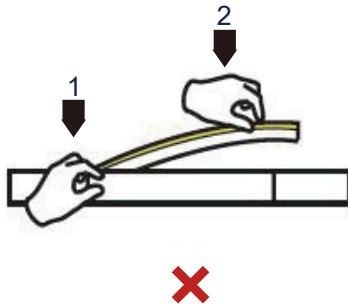
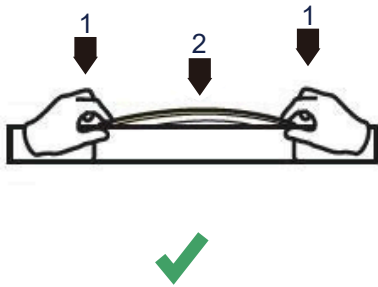

⚠ If the length of LED strip is over 2m, it is recommended to install by two persons.

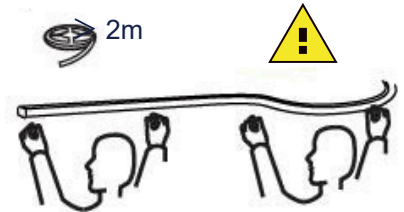

2. Use tool to disassemble carefully, and do not pull the LED strip directly.

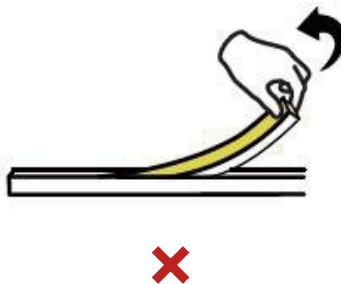
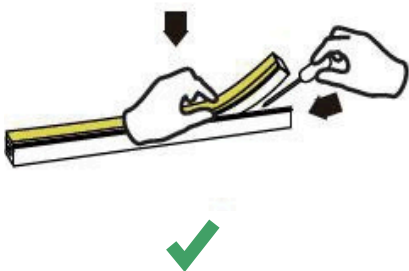

⚠ If the length of LED strip is over 2m, it is recommended to disassemble by two persons.

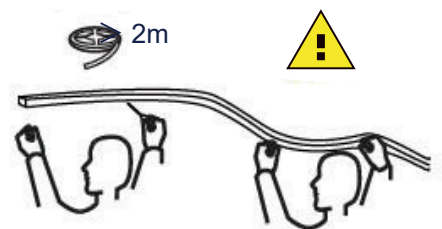

Cautions

- Please notice that the strips are not bendable to all directions. As the appropriate specific shape and degree, please follow the following instruction.
- LED strips are low voltage products, you must use the power supply (transformer). Please don't connect the led strip directly to the AC 110V or AC 220V. Otherwise, it will burn out the LED strips and lead to safety (security) accidents.
- Please read the specifications thoroughly before installation by professional staff to make sure the safe use.

Wrong bending way

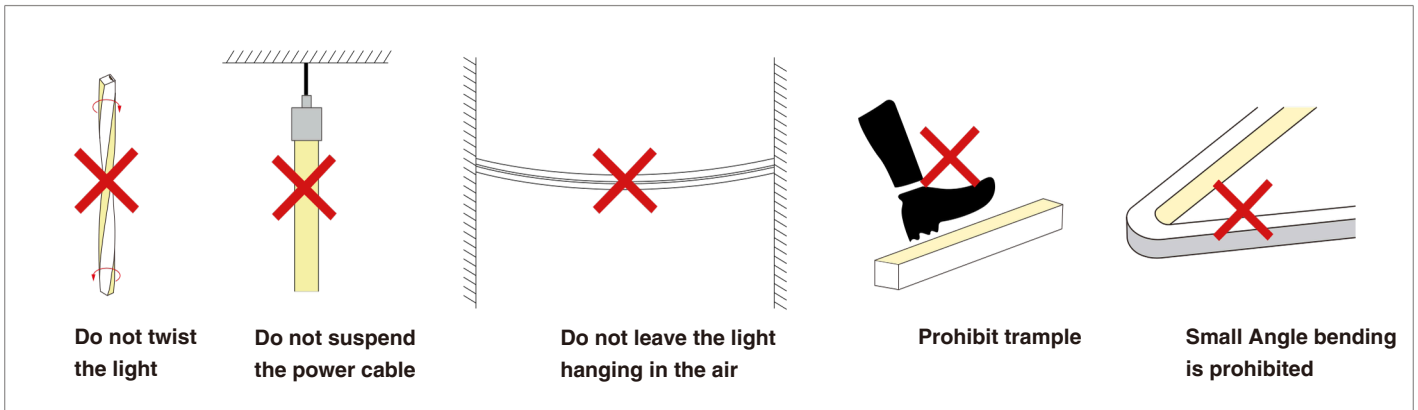

Correct bending way

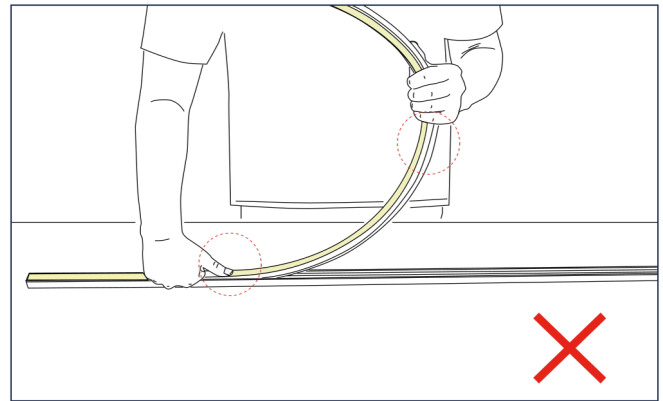
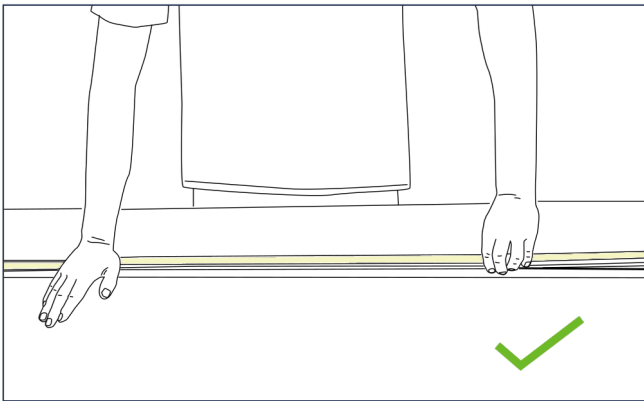

- Please press the led strip with your palm to slowly insert the led strip into the groove, and gently straighten the led strip above the groove with your right hand.
- Try to keep the led strip in a flat state during the installation process.
- Do not press the led strip with a single finger, it is easy to damage the internal parts of the led strip.
- The bent arc of the led strip should not be too large during installation.

Installation Precautions

(If the length of the light is more than 2 meters, two persons must work together to install it.)

Figure 1

Figure 2

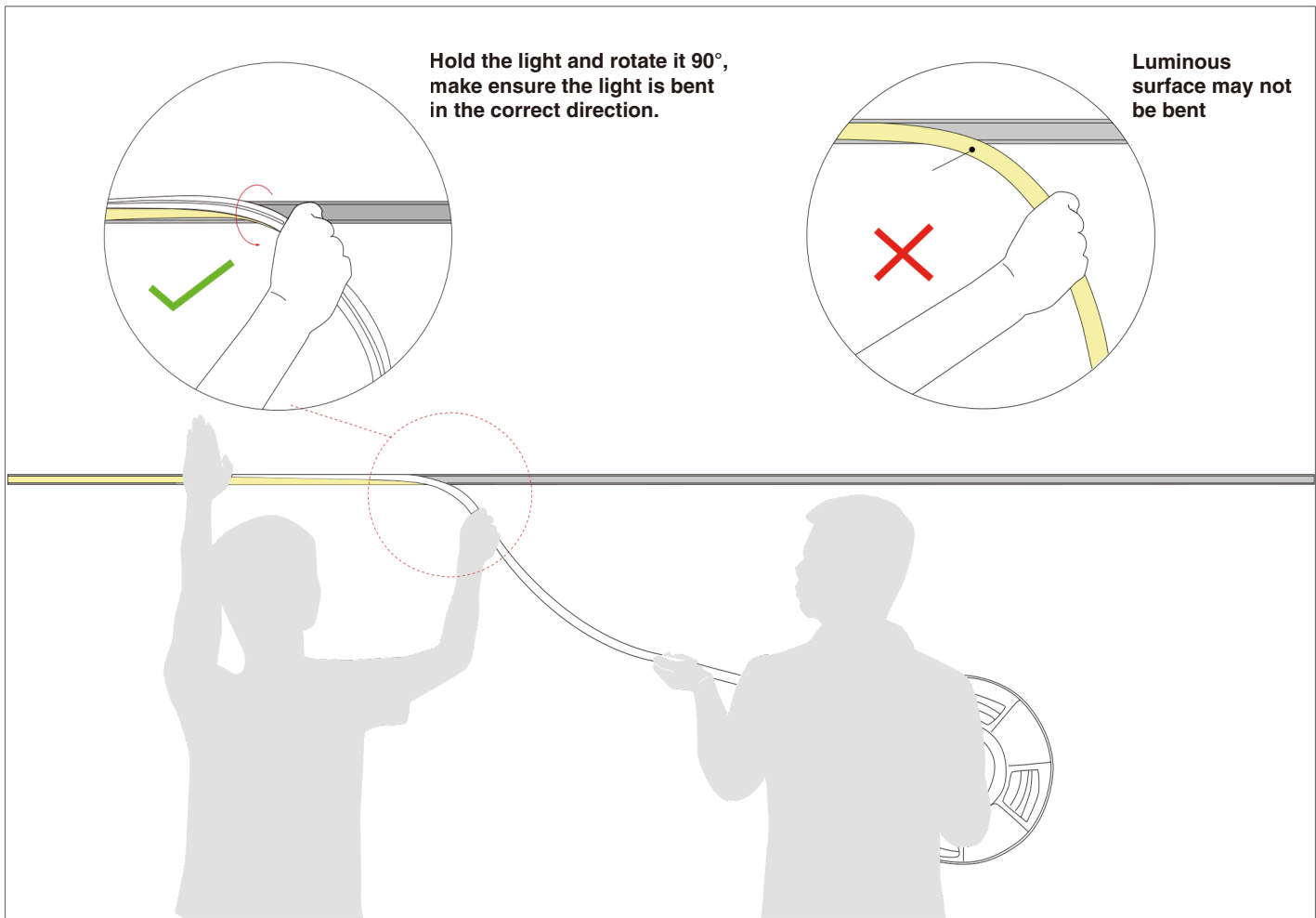

1. Installer:

- Press the light with the palm of the left hand to slowly load it into the slot. Straighten the light with right hand, hold it and rotate it 90° to droop it in the direction of your hand. See Figure 1.
- Do not bend the luminous surface to the side. See Figure 2.

2. Assistant:

- Cooperate with the installer to lift the reel of the light, and then slowly deliver the light to installer. Do not pull or twist the light during the installation.

Package of neon strip (5M/Roll)

