

## 24V Dimm-Controller BLE

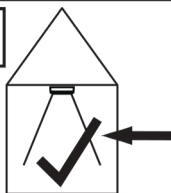

IP  
20



24 V DC

W max. 120 W

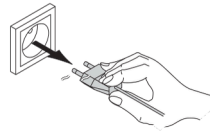

MeshleController to connect to electronic safety isolating converter LED 24V...W to dim and switch. Easy plug-in connection for new or existing installations; this product is for indoor use only.



1. Disconnect from the mains supply before attempting to mount/ dismantle the lighting fixture.
2. Faulty parts should only be replaced with original parts. Always fully insert all plug connections.
3. Connection only to special LED - Converter Hera Type LED 24V...W with a constant output voltage 24 V DC.
4. The total load may not exceed the nominal load of the converter.
5. The specified installation distances of the converter must be maintained.
6. The controller has a memory function of the performance before a disconnection from the mains.
7. After reestablish the mains connection the LED luminaires operate in the performance before the power failure.
8. Range of the signal up to 15 m indoors Bluetooth must be switched on. If required, authorisation to use Bluetooth must be granted.
9. A corresponding dialogue will appear in the app

## 24V Dimm-Controller BLE

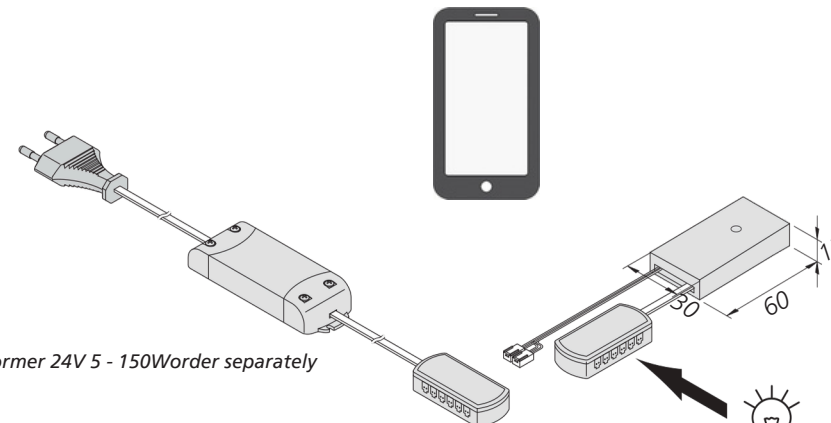

transformer 24V 5 - 150W order separately



beide LED 24-Stecker müssen in den Verteiler des Trafos gesteckt werden  
both LED 24 plugs must be inserted in the 12-way distributor of the converter

### Assembly

Connect the LED converter to the mains.

Connect the Controller to the distributor of the converter.

Connect the LED luminaires to the distributor of the Controller.

Download and Installation of the MESHLE App



system requirements:

iOS 12.0 and up  
Android 6 and up  
Download size 33 MB



Get it on  
App Store



ANDROID APP ON  
Google play

### Configuration

Press the start button and select the desired BT device or network.

For a new device, a network is automatically created and password-protected

The password must be at least 6 characters long

30 units can be connected per network

Several networks can be created and you can switch between them at any time.

## 24V Dimm-Controller BLE



### Add a new device to an existing network

Press the „plus symbol“ in the app

Selection appears: „What would you like to add“-device

Select the desired device and add it

### Reset controller to factory settings

Press button > 10 seconds==reset the controller. A red LED lights up in the housing

After the reset, the unit is reset to the factory settings and appears as a new unit to be configured in the app.

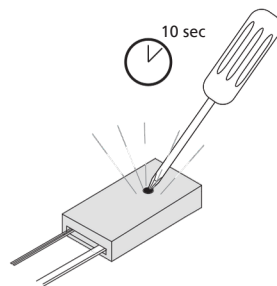

For more FAQ please visit



## 24V Dimm-Controller BLE



Do not dispose of electrical appliances in household waste, use separate collection facilities. When replacing old appliances with new ones, the retailer is obliged by law to accept to take back your old appliance for disposal free of charge.

